

# MHT PoE IP Platform and Lighting with Belden Connectivity Solutions

MHT Technologies' Inspextor® platform connects PoE sensors, devices and systems, such as shades, access control, lighting and office furniture, to optimize in-building occupant experience, sustainability and productivity.

Belden's REVConnect® Connectivity solution allows for futureproofing with easier and faster installation, fewer errors and rework, resulting in lower total cost of ownership. Its breadth of products allows facilities to standardize cables and connectivity across systems.

The combination that these two innovators bring is especially beneficial for healthcare, hospitality, data center and commercial building applications.



ECOSYSTEM



APPLICATION GUIDE



**Learn more:** Use this QR code to access literature, applicable products and more information on Belden's Partner Alliance Ecosystem.

# Belden and MHT Network Topology

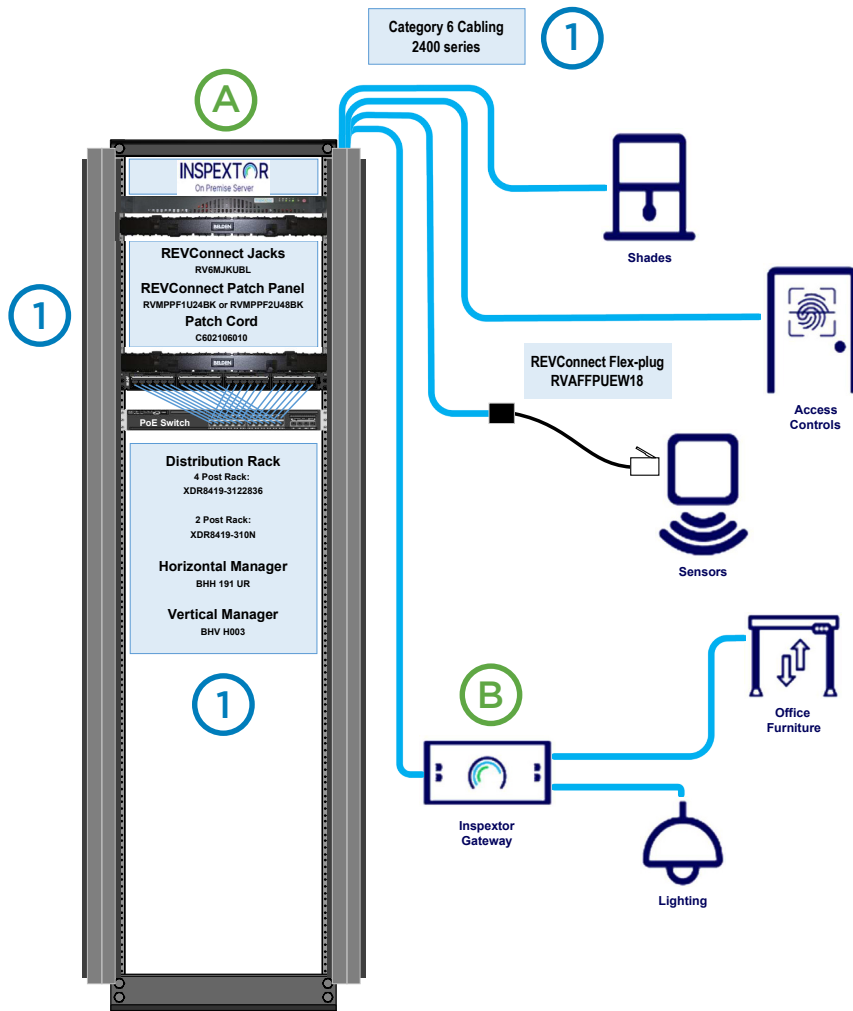

## Additional Benefits

### Customer Experience:

Enhance customer comfort with optimized lighting, temperature and shade controls. Occupancy-activated lighting also provides peace of mind.

### Sustainability:

Increase energy efficiency by linking powered systems and devices with room occupancy.

### Productivity:

Elevate efficiency with access-based, preconfigured room and furniture settings, reducing setup time for functional activities.

*PoE infrastructure can be installed by ICT (information and communication technology) installers, streamlining the process.*

Belden*	Product Type	Description
1	Category 6 Products	Belden's Category 6 cables, plugs and jacks, FlexPlugs, patch cords, patch panels, managers and racks
MHT**	Product Type	Description
A	Inspextor® Server	Rack-mounted server allows users to control thousands of Inspextor and third-party LED fixtures across the Inspextor-based communication network
B	Inspextor Hardware	Hardware supports the connection of PoE devices via one platform

\*See page 3 for additional information on Category 6 products

\*\*See this link for more information on Inspextor products/hardware:  
[Inspextor → MHT Technologies \(mht-technologies.com\)](https://www.mht-technologies.com)

## Category 6 Example

	Belden Part Number	Description
<b>Cables</b>		
	2413	DataTwist 2400 Cables, UTP, 4-pair, 23 AWG, CMP
	2412	DataTwist 2400 Cables, UTP, 4-pair, 23 AWG, CMR
	2146A	2400 Indoor/Outdoor CMR/CMX Outdoor 4-pair, 23 AWG, PVC Jacket, Unshielded (UTP)
	2149A	2400 Indoor/Outdoor CMR/CMX Outdoor 4-pair, 23 AWG, PVC Jacket, Shielded (F/UTP)
	OSP6U	CAT6 Outside Plant OSP 4-pair, 23 AWG, Gel Filled, PE Jacket, Unshielded (UTP)
	OSP6F	CAT6 Outside Plant OSP 4-pair, 23 AWG, Gel Filled, PE Jacket, Shielded (F/UTP)
<b>Plugs and Jacks</b>		
	RV6MJKUBK-S1	CAT6+ REVConnect Modular Jack, Black
	RV6MJKUBL-S1	CAT6+ REVConnect Modular Jack, Blue
	RV6MJKUEW-S1	CAT6+ REVConnect Modular Jack, Electric White
	RV6FFPUBK18-S1	CAT6+ UTP REVConnect FlexPlug, Black
	RV6FFPUEW18-S1	CAT6+ UTP REVConnect FlexPlug, Electric White
<b>Patch Cords</b>		
	C601106007	CAT6+ Modular Patch Cord, UTP, Bonded-Pair, 24 AWG Solid, CMR, T568A/B-T568A/B, Blue, 7 ft
<b>Patch Panels</b>		
	RV6PPF2U48BK	CAT6+ REVConnect Patch Panel 48-port, 2U, Black (Preloaded)
	RV6PPF2U48WH	CAT6+ REVConnect Patch Panel 48-port, 2U, White (Preloaded)
	AX103115	KeyConnect Patch Panel, 48-port, 2U (Empty)
<b>Cabinets and Enclosures</b>		
	XH1M42	XHM Series — Multi-Media, Server Cabinets
	HWVMP012401	Vertical Cable Manager - mounts in rear section using brackets or in mid-section on rail struts
	HWFS24	Vertical Finger Strip Manager
	XHW24RLS1224	(1) Pair of EIA Rails tapped #12-24 with (20) pcs mounting hardware included
	XHW24BBD	Plywood Backboard Kit - mounts in rear section using brackets

Visit our Customer Innovation Center in Chicago to see MHT's PoE lighting in our Healthcare Solutions.