

REVISION HISTORY					
REV.	DATE	EDP NUMBER	DESCRIPTION	REV BY	APPR BY
A1	2012 FEB 14		INITIAL ISSUES	SAC	

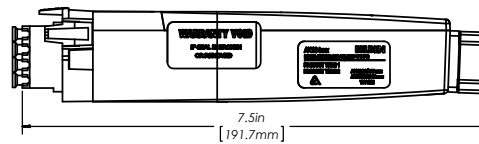
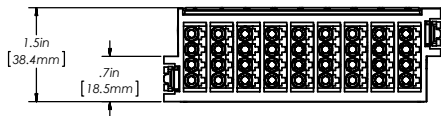
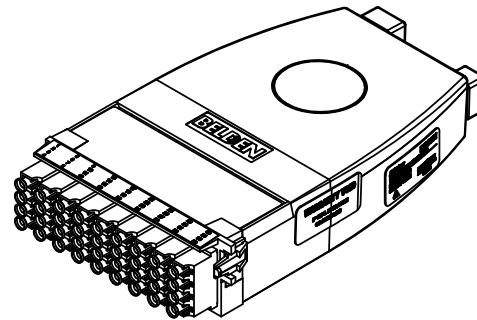
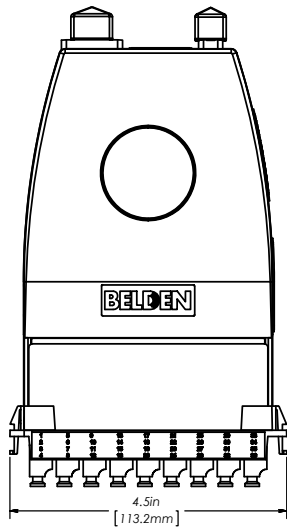

BELDEN PART NUMBER	
PART NUMBER	DESCRIPTION
AX104616	FiberExpress Ultra HD Pre-Terminated Cassettes18 x LC Duplex to 3 x MPO (m), 36 fibers, OM2
AX104617	FiberExpress Ultra HD Pre-Terminated Cassettes18 x LC Duplex to 3 x MPO (m), 36 fibers, OM3
AX104658	FiberExpress Ultra HD Pre-Terminated Cassettes18 x LC Duplex to 3 x MPO (m), 36 fibers, OS2

DESSIN NON À L'ÉCHELLE / DRAWING NOT TO SCALE

**PROPRIÉTÉ INTELLECTUELLE**  
L'information contenue dans ce document est la propriété de BELDEN Inc. Seul si spécifié par une autorisation écrite de BELDEN Inc, la personne qui consulte ce document : (1) doit garder confidentielle toute l'information contenue dans ce document et doit protéger en tout ou en partie toute divulgation à toute tierce personne et (2) doit utiliser l'information pour la production ou la mise à jour.

**PROPRIETARY INFORMATION**  
The information contained in this document is the property of BELDEN INC. Except as specifically authorized in writing by BELDEN, INC., the holder of this document: (1) shall keep all information contained herein confidential and shall protect same in whole or in part from disclosure and dissemination to all third parties and (2) shall use same for operating and maintenance purposes only.

DIMENSIONS PAR DÉFAUT EN POUCES  
DEFAULT DIMENSIONS ARE IN INCHES

**TOLERANCES**

Y,XX: ±  
ANG.; MACH: ±  
ANG.; PLUÉ / BEND: ±  
Y,XXX: ±  
Y,XXX: ±

TOL GEOMETRIC SELON:  
GEOMETRIC TOL PER: **ASME Y14-43**

MATÉRIAU / MATERIAL

FINI / FINISH

EDP  
DESSINE  
DRAWN

VERIFIÉ  
CHECKED

APPR ING  
ENG APPR

APPR MNF  
MFG APPR

A.Q.  
G.A.

ORIENTATION:

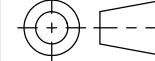

NOM  
NAME

SAC

DATE

2/14/2012



TITRE / TITLE:

FiberExpress Ultra HD  
Pre-Terminated Cassettes

FORMAT  
SIZE

D

DESS NO / DWG. NO.

BELDEN-396

REV

A1

CAO / CAD

POIDS / WEIGHT  
(lbs)

FEUILLE DE  
SHEET 1 OF 1