

NOTES

- 01. ALL DIMENSIONS ARE IN INCHES AND [MILLIMETERS].
- 02. ALL DIMENSIONS SHOWN AS REFERENCE ONLY

DATE 2008 JUL 23

DES/DRW APP REV

QA BL A

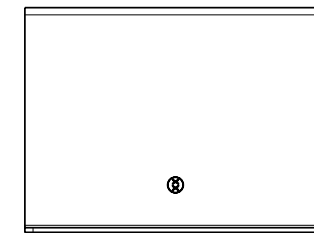
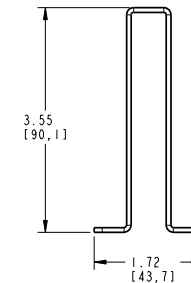
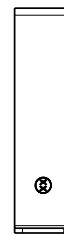
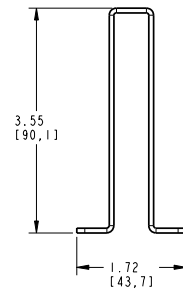
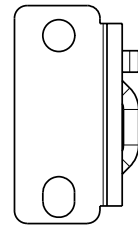
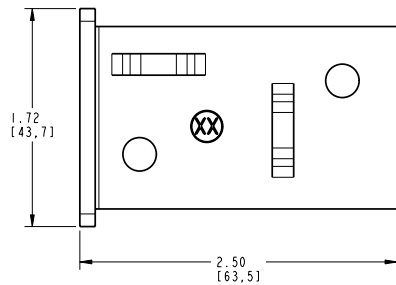
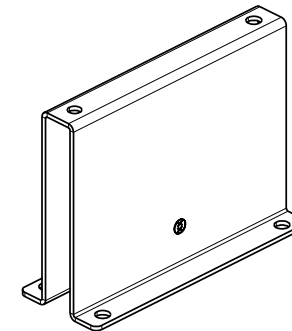
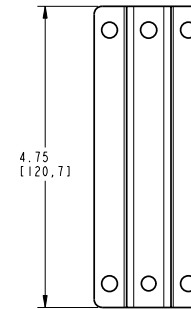
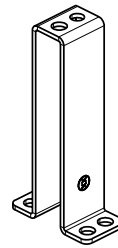
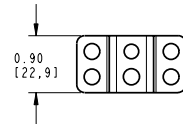
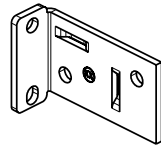
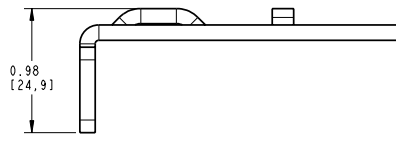

FX12RM 5° OFFSET BRACKET

FX12RM AND FX24RM 5° OFFSET RECEPTACLE FOR RACK 19"

FX12RM AND FX24RM 5° OFFSET RECEPTACLE FOR RACK 23"

INFORMATION SUR LE PRODUIT PRODUCT INFO		
NUMÉRO DE PIÈCE PART NUMBER	CODE DU PRODUIT PRODUCT CODE	DESCRIPTION
AX101799	NX7L26BA3	FX12RM 5° OFFSET BRACKET KIT BLACK
AX101800	NX7L26BA4	FX12RM 5° OFFSET BRACKET KIT GREY

PROPRIÉTÉ INTELLECTUELLE
L'information contenue dans ce document est la propriété de BELDEN Inc. Sauf si spécifié par une autorisation écrite de BELDEN Inc. la personne qui consulte ce document : (1) doit garder confidentielle toute l'information contenue dans ce document et doit protéger en tout ou en partie toute divulgation à toute tierce personne et (2) doit utiliser l'information pour la production ou la mise à jour.

PROPRIETARY INFORMATION
The information contained in this document is the property of BELDEN INC. Except as specifically authorized in writing by BELDEN, INC. the holder of this document: (1) shall keep all information contained herein confidential and shall protect same in whole or in part from disclosure and dissemination to all third parties and (2) shall use same for operating and maintenance purposes only.

BELDEN
SENDING ALL THE RIGHT SIGNALS™

PAGE / SHEET 1 DE / OF 1

DESSIN NON À L'ÉCHELLE
DRAWING NOT TO SCALE

TITRE / TITLE
**FX12RM
5° OFFSET BRACKET
KIT**

NUMÉRO DE DESSIN/DRAWING NUMBER

BELDEN-144